

ULTIMATE-50CC



Radio: 4-5 channels 8-9 servos
Engine: 50CC

Thank you very much for purchasing our product.

Specifications

Wing span	1790mm
Fuselage length	1900mm
Flying weight	8000g-8500g
Wing area	101dm ²

Warning! This model is not a toy.

It is designed for maximum performance. Please seek advice if one not familiar with this kind of engine powered precision model. Operating this model without prior preparation may cause injuries. Remember, safety is the most important thing. Always keep this instruction manual at hand for quick reference.

ULTIMATE-50CC

INDEX

BEFORE YOU BEGIN P. 1
 PARTS LIST P. 2-P. 3
 ASSEMBLY P. 4-P. 10
 SAFETY PRECAUTIONS P. 10

BEFORE YOU BEGIN

- ① Read through the manual before you begin , so you will have an overall idea of what to do.
- ② Check al prts. If you find anky defective of missing parts contact your local dealer.
- ③ Symbols used throughout this instruction manual comprise of the following:



Apply epoxy glue.



Apply instant glue
(C. A. glue, super glue.)



Assemble left and right
Sides the same way.



Ensure smooth non-binding
movement while assembling.



Peel off shaded portion
Covering film.



Cut off shaded portion.



Drill holes with the specified
Dameter (here : 3mm)



Must be purchased separately!



Pay close attention here!



Warning!

Do not overlook this symbol!

17 C. G

The ideal C.G. position is 105mm behind the leading edge. In order to obtain the C.G. specified ,add weight to the fuselage if required. Check the C.G. before flying.

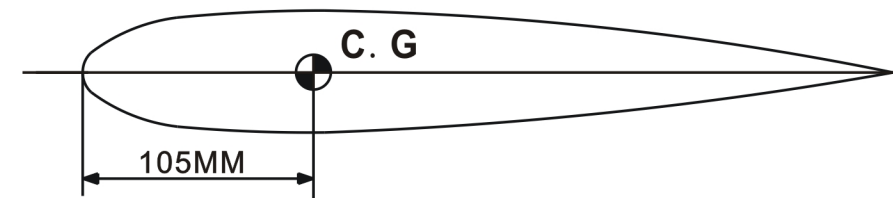

! Warning

Important Safety Precautions

- #First time flyer should never fly by himself/herself. Assistance from experienced flyer is absolutely necessary.
- #Pre-flight adjustment must be done before flying, it is very dangerous to fly a badly Pre-adjusted aircraft.
- #Katana is designed to be powered by 100 C. C out brush less electric motor. using a more powerful engine does not mean better performance. In fact, over powered engine may cause structural damage and injuries.
- #Make sure the air field is spacious, never fly the plane too close to people and never get too close to a running propeller.
- #If you find wrinkles on the covering as a result of weather changes, you can use hot iron to remove the wrinkles. Please begin with lower temperature setting and gradually raise the temperature until the wrinkles are gone. Too hot an iron may damage the covering.
- #Check and re-tighten up all factory assembled screws, use thread locker if applicable.

14 Canopy

- PM3X12 Socket — 2
- 3mm Washer — 2

L/R

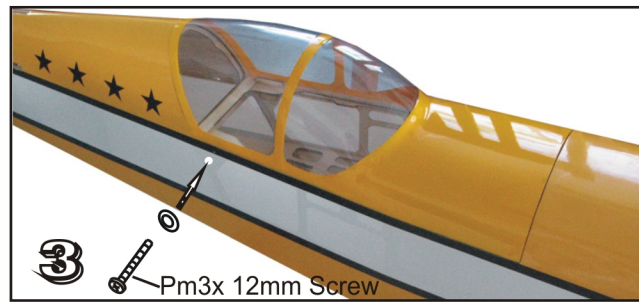
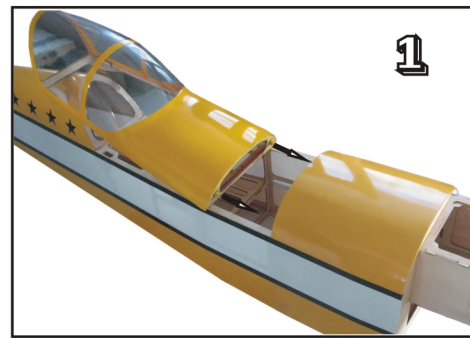

15 C. G Point

Adjust the wing and fuselage configuration as in the diagrams.

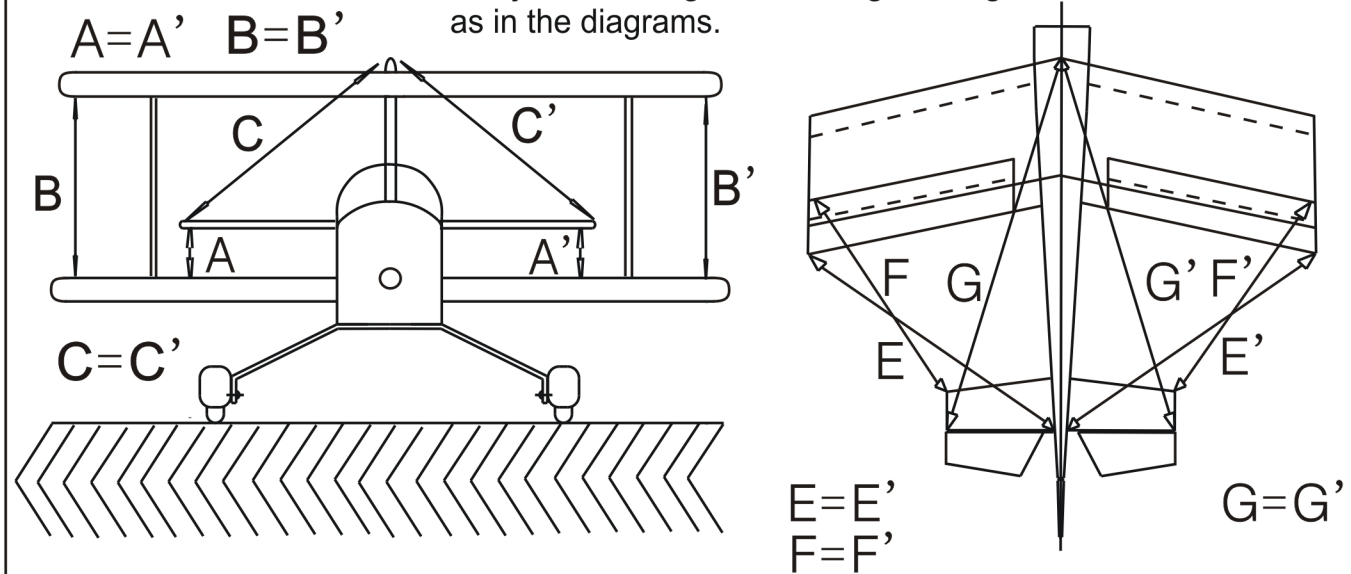

16 Control Throws

Adjust the control throws as shown in the diagram. These throws are good for general flying. You can adjust according to your personal preference.

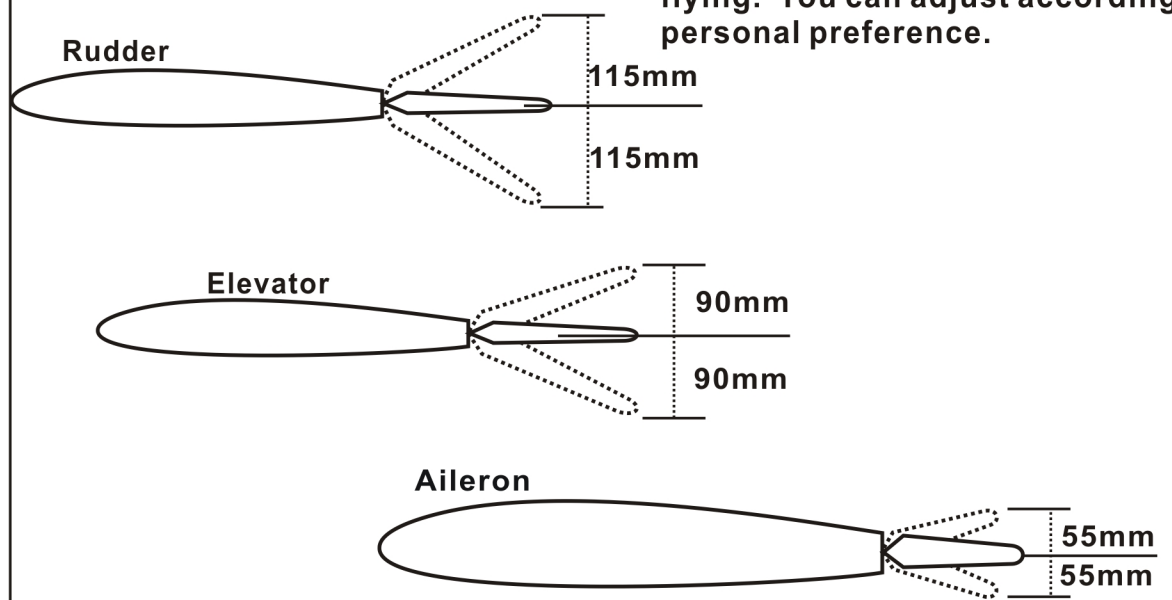

Parts List:

1. Fuselage-1pcs
2. Right top Wing-1pcs
Right descend Wing-1pcs
Left top Wing-1pcs
Left descend Wing-1pcs
3. Horizontal Stabilizer-1pcs
4. Vertical Stabilizer-1pcs
5. Canopy 0.8mm thickness-1pcs
6. Cowl-1pcs
7. Wheel Pant-1set
8. Round Head Screw PMA2. 6X10-5pcs
Round Head Screw PM3X12-2pcs
Flat washer $\Phi 3$ -2pcs
9. Fuel Tank 750CC-1set
Fuel Line $\Phi 5 \times 136$ mm-1set
Rubber Cap-1ser
Round Head Screw -1set
Mount Plate-1set
Aluminium Tube-1set
Clunk-1set
Velcro tape 350-2set
10. Front Landing Gear 5MM-1set
Round Head Screw CM5X20-5pcs
Wheel Axle $\Phi 5$ -2pcs
lock nuts M8-2pcs
Wheel Collar $\Phi 4$.1-4pcs
Wheel $\Phi 80$ MM-2pcs
Metal Screw PA3X16-2pcs
11. Bent steerable tail wire -1set
Tail Wheel $\Phi 35$ MM-1pcs
Metal Screw PA3*16mm -5pcs
Wheel Collar $\Phi 3$.1MM-1set
12. Control Horn Extra strong -6set
Control Horn Link -8pcs
Clevis-8set
Pushrod Head $\Phi 3 \times 30$ -8set
Flat Head Screw PM3*30mm-4pcs
Flat Head Screw PM3*16mm-2pcs
Adjustable Control Horns-2pcs
Self-Tapping Screws PM2*35mm-6pcs
Adjust bar M3*33mm-4pcs
Wire rope $\Phi 0.8 \times 1000$ mm-2pcs
Copper buckle $\Phi 2 \times 8$ mm-4pcs
Nylon E/Z Link-1pcs
EZ Connector $\Phi 2.1$ -1pcs
13. Wire pushrod $\Phi 3 \times 67$ -4pcs
Wire pushrod $\Phi 3 \times 110$ -2pcs
Wire pushrod $\Phi 1.8 \times 300$ -1pcs
14. Fuselage canopy 120x112x2mm-1pcs
Servo canopy 86x70x2mm-4pcs
Button Head Sheet Metal Screw PWA2.3x8-20pcs
15. Wing Strut -2pcs
Aluminium Cabane (front) -2pcs
Aluminium Cabane (Back) -2pcs
Aluminium Cabane-2pcs
Wing Strut connect-16pcs
Round Head Screw PM3*10mm-8pcs
Hexagon Nuts M3-20pcs
Washers $\Phi 3$ -20pcs
Socket Head Screws CM3*10mm-16pcs
Socket Head Screws CM3*16mm-4pcs
Washers $\Phi 3$ -20pcs
16. Nylon wing bolt CM5*20mm-5pcs
Flat washer $\Phi 5$ -5pcs
Wing bolt $\Phi 28 \times 667$ mm-1pcs
Wing bolt $\Phi 28 \times 408$ mm-1pcs

11 Cowling Spinner

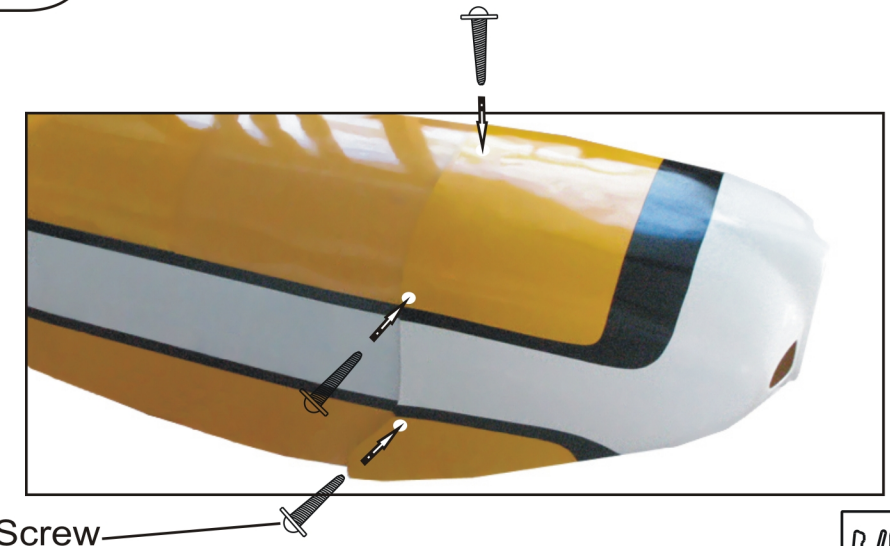

PWA2. 6X10	Socket
	— 5



PWA2. 6x 10mm Screw

L/R

12 Main Wing (Lower)

CM5X20	Screw
	— 2
$\Phi 5$ mm	Washer
	— 2

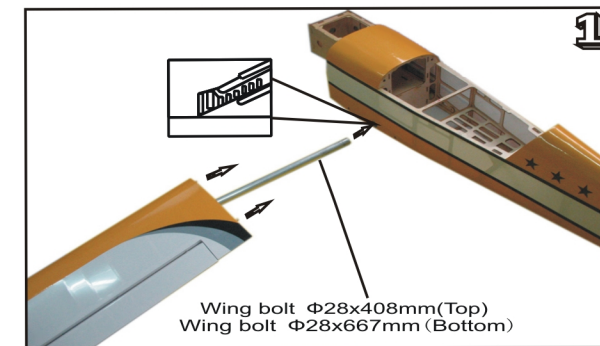

Wing bolt $\Phi 28 \times 408$ mm (Top)
Wing bolt $\Phi 28 \times 667$ mm (Bottom)

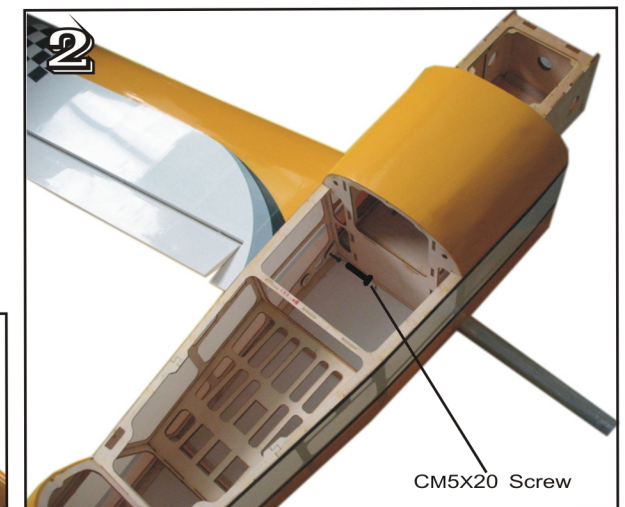

CM5X20 Screw

L/R

13 Aluminium underprop

CM3X12mm Screw	16
CM3X16mm Screw	2
$\Phi 3$ mm Washer	18
M3 Hexagon Nuts	18
$\Phi 3$ mm Washer	18

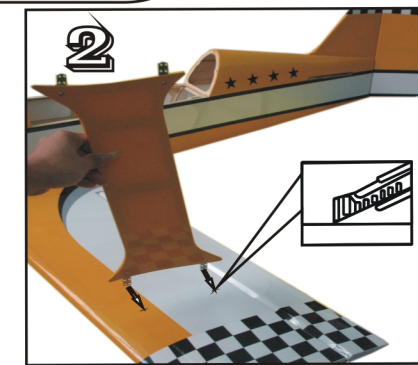

CM3X16mm Screw

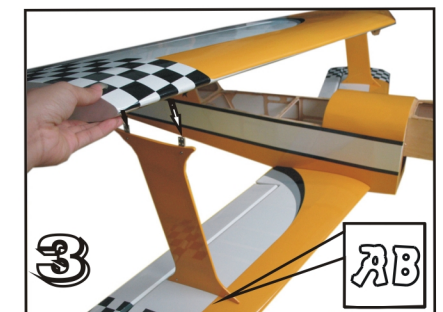

CM3X12mm Screw

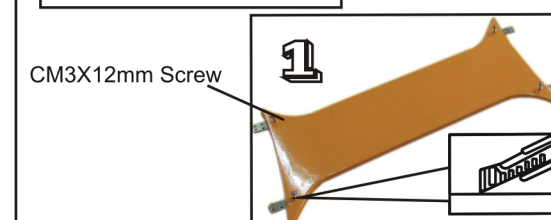

CM3X12mm Screw



9 Cover board



PWA2. 3X8mm Screw
 4

PWA2. 3X8mm Screw

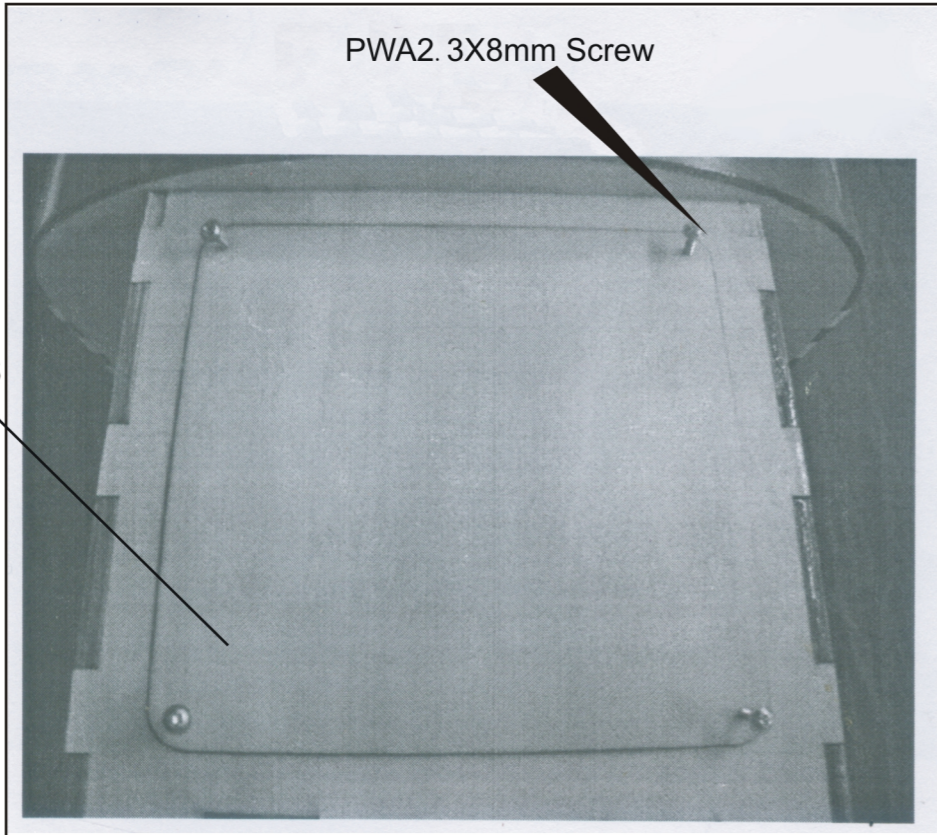
Servo canopy
 120x112x2mm 1PCS



10 Engine

Nylon E/Z Link — 1
 Linkage Stopper

 2mm Nut — 1

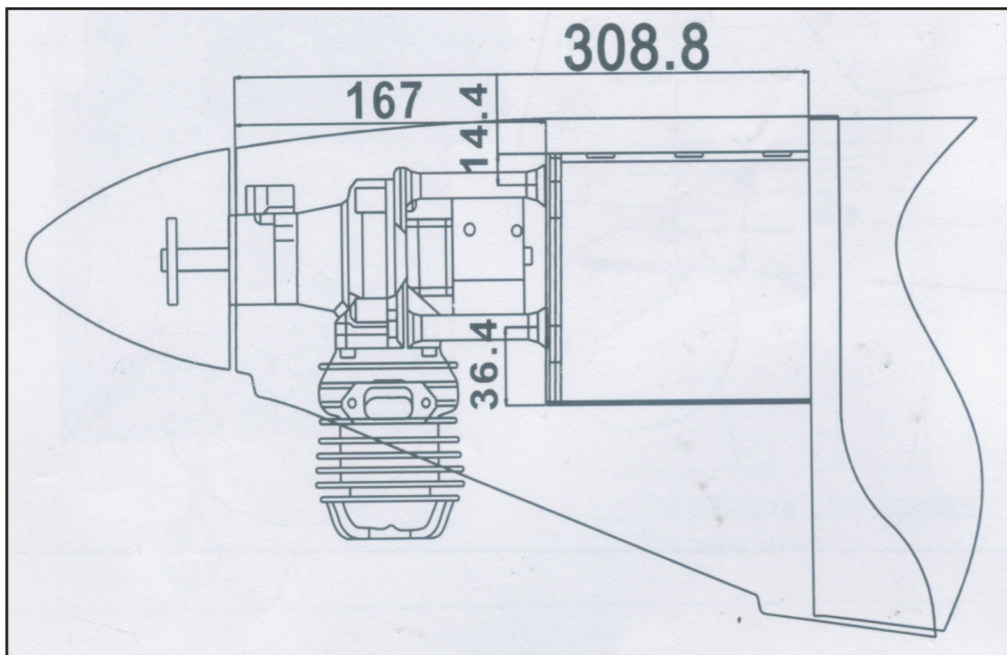
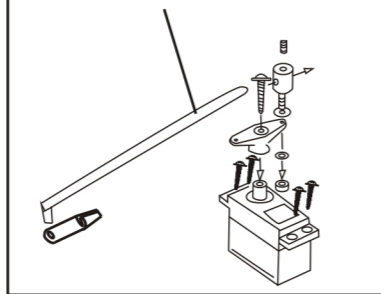
 3X3mm set screw — 1

wire pushrod $\phi 1.8 \times 450$

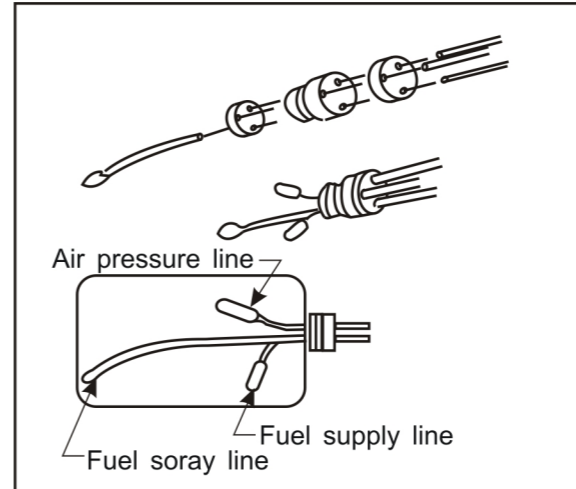

1 Fuel Tank



2 Gemel

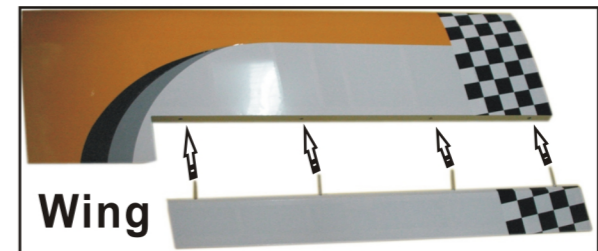

Horizontal Connect

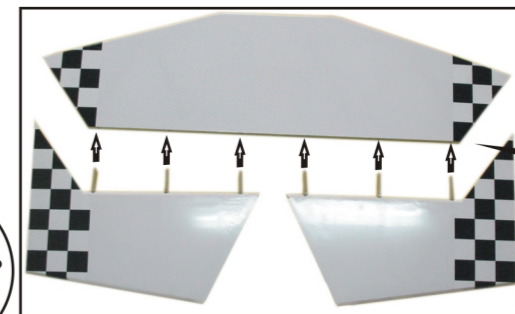
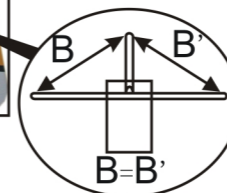
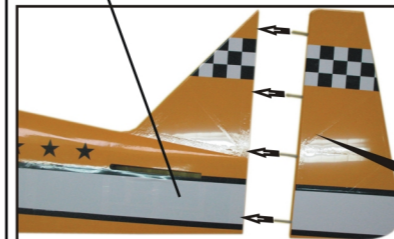

Vertical

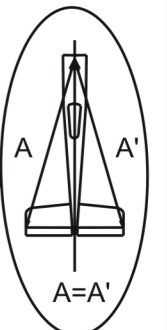

3 Stabilizer/elevator

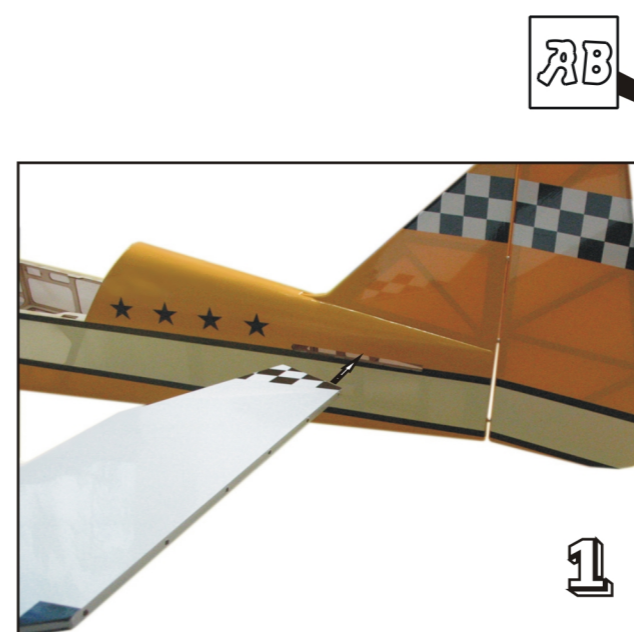

L/R

4 Wing/Servo

L/R

- M3X30 Screw — 4
- M2X16 Screw — 4
- M2X12 Screw — 4
- M2 Hexagon Nuts — 8
- Adaptor — 4
- Clevis — 4
- Control horns — 4
- Control Horn Extra strong — 4
- Control horns — 4

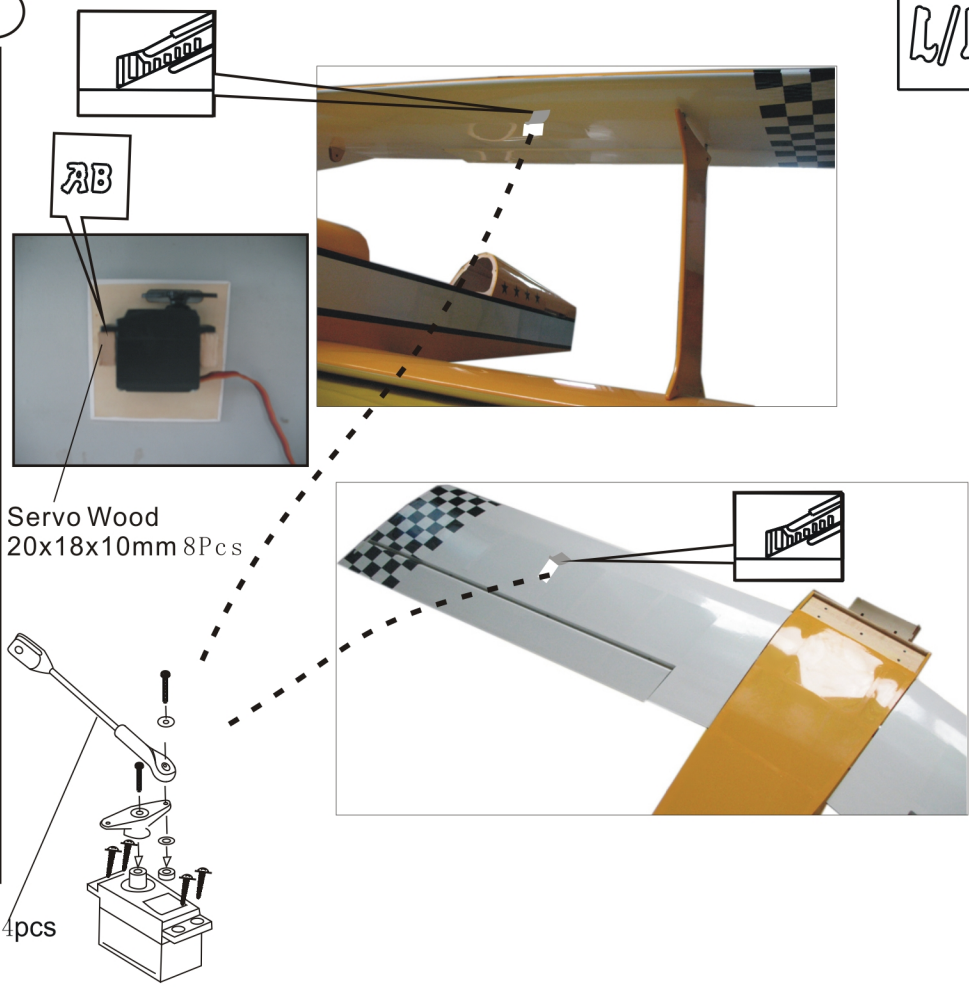

wire pushrod Φ 2.8x67 4pcs

5 Elevator/Servo

- M3X16 Screw — 2
- M2X16 Screw — 2
- M2X12 Screw — 2
- M2 Hexagon Nuts — 4
- Adaptor — 2
- Clevis — 2
- Control horns — 2
- Control Horn Extra strong — 2
- Control horns — 2

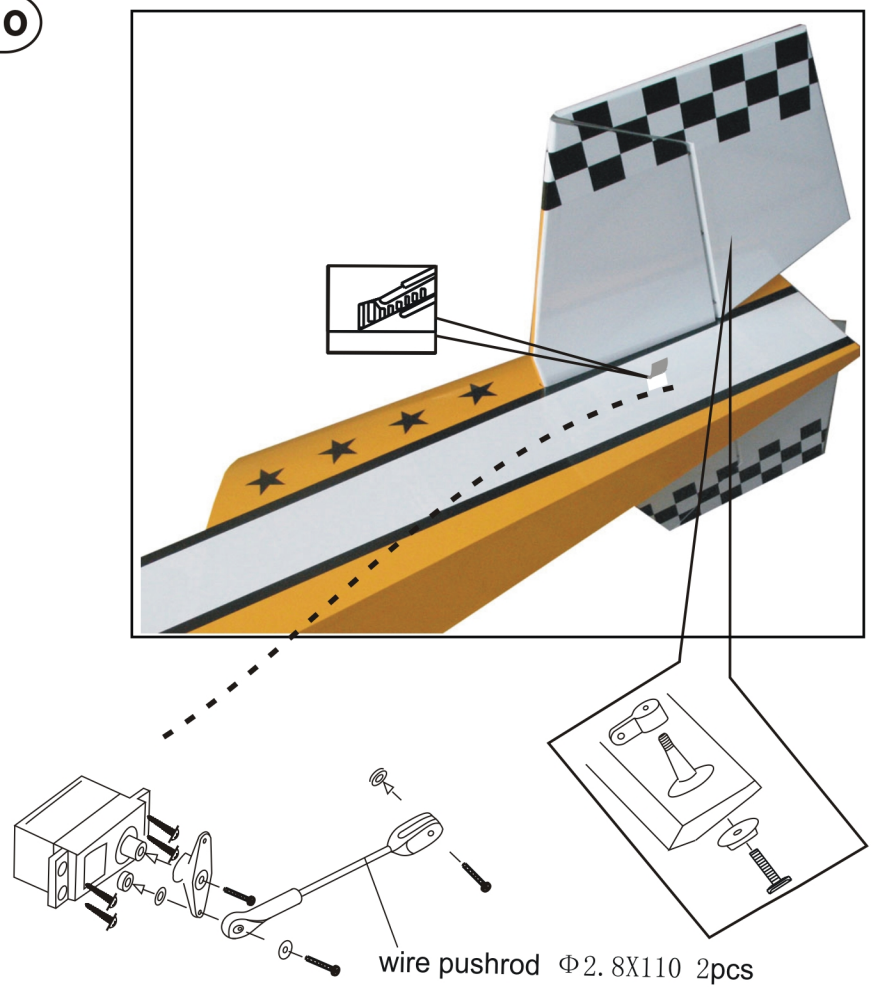

wire pushrod Φ 2.8x110 2pcs

6 rudder/Servo

- Φ 3X33 Adjust bar — 4
- Clevis — 2
- Φ 3X8 copper buckle — 4
- M2X12 Screw — 2
- M2X16 Screw — 2
- Control horns — 2
- PA3x 16mm Screw — 6
- Adaptor — 2
- M2 Hexagon Nuts — 4

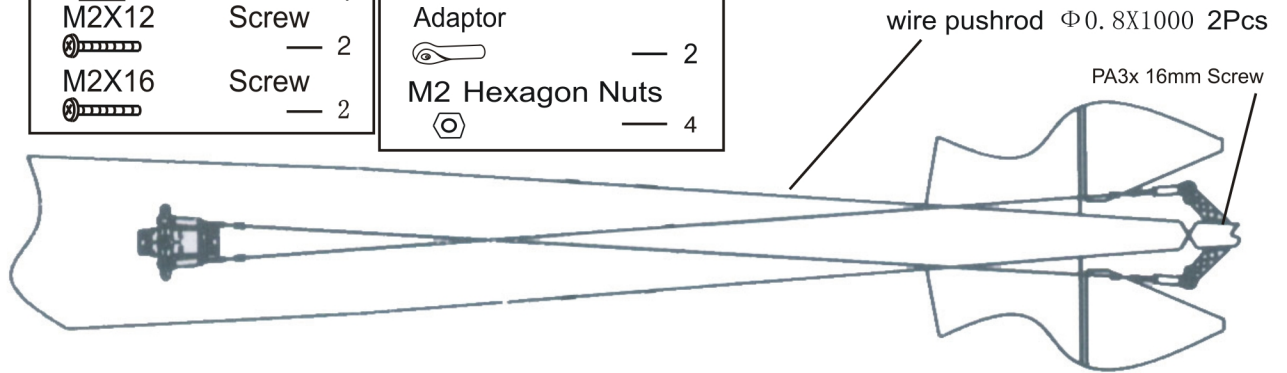

wire pushrod Φ 0.8x1000 2Pcs
PA3x 16mm Screw

7 Main Landing Gear

- Φ 8x50x Φ 4mm Axle Shaft — 2
- M8 Nylon Inert Lock Nut — 2
- Φ 4.1mm Colar — 4
- PWA2.6x10mm Screw — 4
- CM5X20 Socket — 5
- Φ 5.1mm Colar — 5

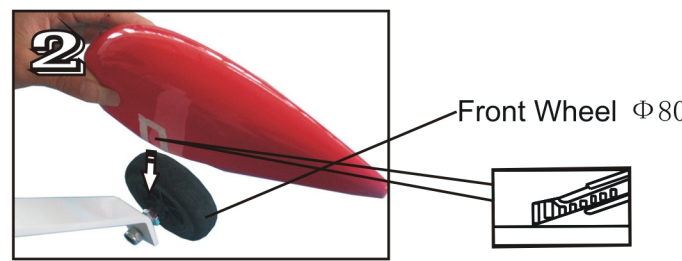
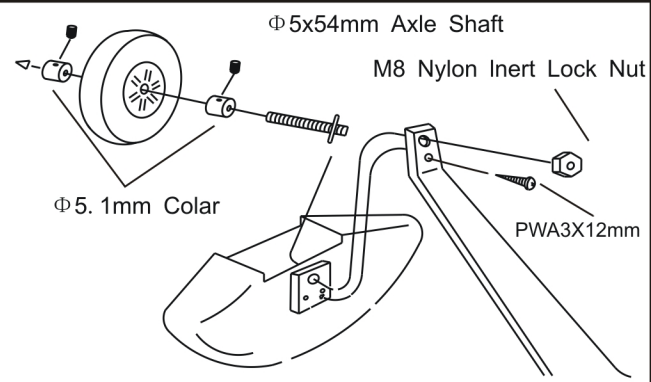

Front Wheel Φ 80

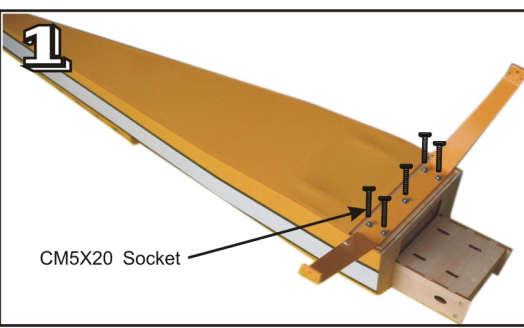

CM5X20 Socket

8 Tail Landing Gear

- PA3X16mm Screw — 5
- Φ 3.1mm collar — 1

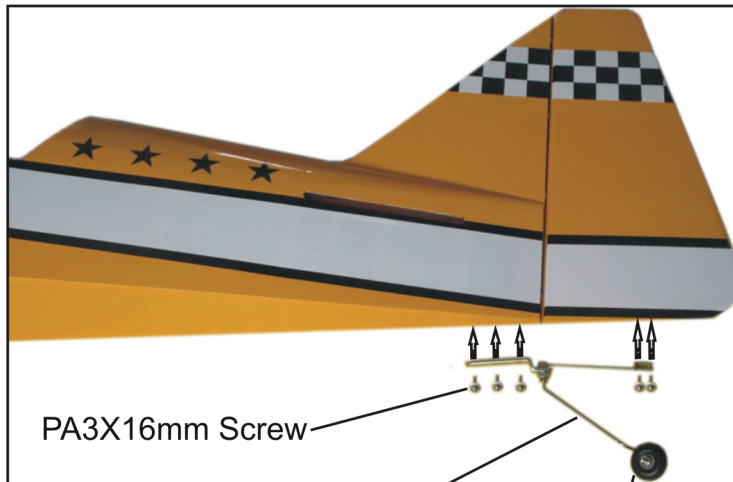

Tail Wheel Assemblies 1set

Back Wheel Φ 35